

Hill Close Gardens Calendar of Events 2023



Date	Event	Time
February		
Sat Feb 4 th & Sun Feb 5 th	Snowdrop Weekend: open gardens (free to HCG and RHS members)	11.00am – 4.00pm
Saturday 11 th February	Art Workshop 'Sketching snowdrops' All levels and experience welcome	TBC
Saturday February 18 th	Snowdrop Open Day: in aid of National Gardens Scheme and Plant Heritage	11.00am – 4.00pm
Tuesday Feb 21 st	'Discovery' – hunt for a new hidden creature in the gardens– Free workshop for 6-9 yr olds	11.30am – 12.30pm
Thursday Feb 23 rd	Family Workshop - Frost and Feathers (£4 per child)	10am – 12.00
March		
Saturday 25 th March	Volunteers and Members get together	10.00am – 12.00
April		
Tuesday April 4 th	'Look around' - what's in the garden? Free workshop for 6-9 yr olds	11.30am – 12.30pm
Friday April 21 st	Head Gardener's Spring Garden Walk ***	2.00pm
May		
Sunday May 14 th	Wellbeing Day – information and activities in the gardens, supporting National Health Awareness Week	Normal opening hours
June		
Thursday June 1 st	Family Workshop – Slimly Slugs and Boggling Bugs (£4 per child)	10.00am – 12.00
Saturday June 10 th	Community Open Day. Free entry for Warwick residents	Normal opening hours
Saturday June 17 th	Volunteers and Members get together	10.00am – 12.00
Tuesday June 20 th	Summer Propagation £25 (RHS/HCG Members £20)	10.00am -12.00
July		
Friday July 14 th	Head Gardener's Summer Garden Walk ***	2.00pm
Saturday July 15 th	'Dr Doolittle' – family performance, followed by : 'Great Gatsby' by Tethered Witts Theatre Company (cost tbc)	5.00pm 7.30pm
August		
Tuesday August 1 st	David Walliams 'Bad Dad' by Heartbreak Productions (cost tbc)	Doors open 5.00pm
Thursday August 3 rd	Teddy Bears' Picnic- bring your bear and a picnic (£4 per child)	2.00pm -4.00pm
Tuesday August 8 th	Summer Pruning Workshop £25 (RHS/HCG Members £20)	10.00am – 12.00
September		
Sat & Sun September 9 th –10 th	Heritage Days. Free entry	Normal opening hours
Friday September 15 th	Head Gardener's Autumn Apple Walk***	2.00pm
October		
Sunday October 8 th	Apple Day and Country Fair – arts and crafts and a celebration of all things apple	Normal opening hours
Saturday October 28 th	Chrysanthemum Day: in aid of National Gardens Scheme and Plant Heritage	Normal opening hours
November		
Thursday November 2 nd	Hedgehog Day- a spectacularly 'snuffling and spikey' event (£4 per child)	10.00am - 1.00pm
Saturday November 11 th	Volunteers and Members coffee morning	10.00am – 12.00
December		
Thursday December 7 th	Festive Family Christmas Workshop (£4 per child)	3.30pm – 6.00pm

Normal opening hours apply unless stated on the calendar

Entrance fees – Adults £5 Children 5-17yrs £1. Under 5s, HCG and RHS Members free

Becoming a member has so many benefits -ask for more details

Additional information

Winter opening times: Tuesday – Saturday 11.00am – 4.00pm January – March. Closed Mondays.

Closed to the public from Friday 16th December until Monday January 9th 2023

Summer opening: Monday – Friday 11.00am – 5.00pm April – October. Tearoom open Saturday, Sunday and Bank Holiday selling locally made cakes and refreshments. Self-service hot drinks, biscuits and snacks available weekdays.

Free access to nursery /plant and seasonal produce sales

‘Grow and Explore’ is our monthly Drop In for preschool children their parents/carers and is on the 2nd Thursday of each month. £4 per child over 2yrs, siblings £1. See website or Face Book for more details or email educationofficer@hcg.org.uk Please dress for the outdoors - wellies always a good idea!

New for 2023 – Sessions for primary aged children

Discovery – Are you ready for an adventure? This workshop will transport children to a world of discovery where they will join us on the hunt for a new hidden creature! Children will need to use their creative writing skills to describe and capture what they have seen! We can't wait for our adventure! Suitable for children aged 6-9.

Look around -what's in the Garden? - Look left, look right, look up, look down, look all around – what will we find? Come and join us on an observation adventure at Hill Close Gardens. Children will join us in discovering the delights of the gardens before using their data analysis skills to construct a variety of graphs and a summary of what they found! Suitable for ages 6-9

Art in the Gardens Look out for a series of workshops which will focus on exploring the beauty of the gardens, using a variety of styles and mediums. No prior knowledge nor experience required, just an enthusiasm and interest in discovering hidden artistic talents! The first session will be on Saturday Feb 11th ‘Sketching Snowdrops’. More details to follow.

Gardening Workshops and Head Gardener's walks marked ** booking essential – Tel. Centre Manager on 01926 493339. Email centremanager@hcg.org.uk or see our website for more details.

In our new visitor room, we have touchscreen TVs and historical information about our rare Victorian detached leisure gardens. We have a small gift shop where we showcase local artists.

Guided Tours are available on request, and we are available for private functions, such as parties, weddings, meetings etc. We have wheelchair/mobility access and baby changing facilities available.

For more information: call in at Hill Close Gardens, Bread and Meat Close, Warwick CV34 6HF

Entrance is from car park on Bread and Meat Close (off Friar Street) opposite the racecourse, with 2hrs free parking

Email us: centremanager@hcg.org.uk

Website: www.hillclosegardens.com or follow us on Facebook and Instagram

HCG is a company registered in England No. 3981067 Charity No. 1085278

Supported by WDC the Heritage Fund.

The Hidden Hedged Gardens of Warwick - a brief history

Hill Close Gardens are rare survivors of Victorian detached gardens (once found in many urban areas) used by townsfolk who lived above their businesses in the town centre and had nowhere to grow flowers, fruit or vegetables in their small



Plot 22 reconstruction

back yards. In the mid-1840s the owner of Hill Close divided his land into 32 plots and rented them out to the townspeople to be used as detached

gardens. As can be seen in the Warwick Board of Health Map of 1851, the plots were laid out with hedges, entrances, paths and summer houses or sheds and there is evidence of fruit trees and ornamental planting. The summer houses were mostly wooden but some were later built in brick. By 1860 the plots had been sold freehold to individual families and this has contributed to their survival, as has lack of road access. Unfortunately now only 16 plots remain as land to the north, east and west was sold off for housing in Edwardian times.

Some owners cultivated their own plots but others rented them out. The Pratt family, for instance, who were druggists and chemists owned Plot 12 for 100 years and Plots 13 and 14 (now built on) for 32 years. They



Plot 19 vintage tools

cultivated Plot 12 for the majority of the time. Other owners kept their plots for investment and rented them out for £120-£150 a year.



Victorian style Glasshouse

Again, some tenants remained for a number of years but others like Leonard Baldwin, hotel keeper of the Warwick Arms Hotel in the High Street, used the plot for only two years. The plot occupants used them to grow fruit, vegetables and flowers.

The gardens continued to be cultivated until after the Second World War when Warwick District Council began to buy up the plots for housing, after which they gradually became derelict. When diggers were seen entering the area in the early 1990s, a local resident alerted the neighbourhood and that was the start of the rescue of Hill Close Gardens, with one of the deciding factors being the designation of four of the summer houses as Grade 2 listed buildings. The site was listed later that year.

Many volunteers have been involved in the rescue, restoration and continue to maintain the Gardens. The full story of the rescue is told in the Guidebook available in the Centre.



Plot 22 in Autumn

Welcome

HILL CLOSE GARDENS WARWICK

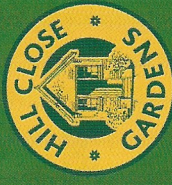

Going round the gardens

Please take care as you go round the gardens. Footpaths and steps may be uneven and slippery.

Watch out for over-hanging and thorny branches.

Please do not touch plants or take cuttings.



Most of the gardens are accessible by wheelchair, however some paths are narrow and steep in places. We therefore request you to exercise appropriate care taking into account the type of wheelchair and the prevailing conditions. Please ask if you require any advice or assistance.



Harvesting for Apple Day

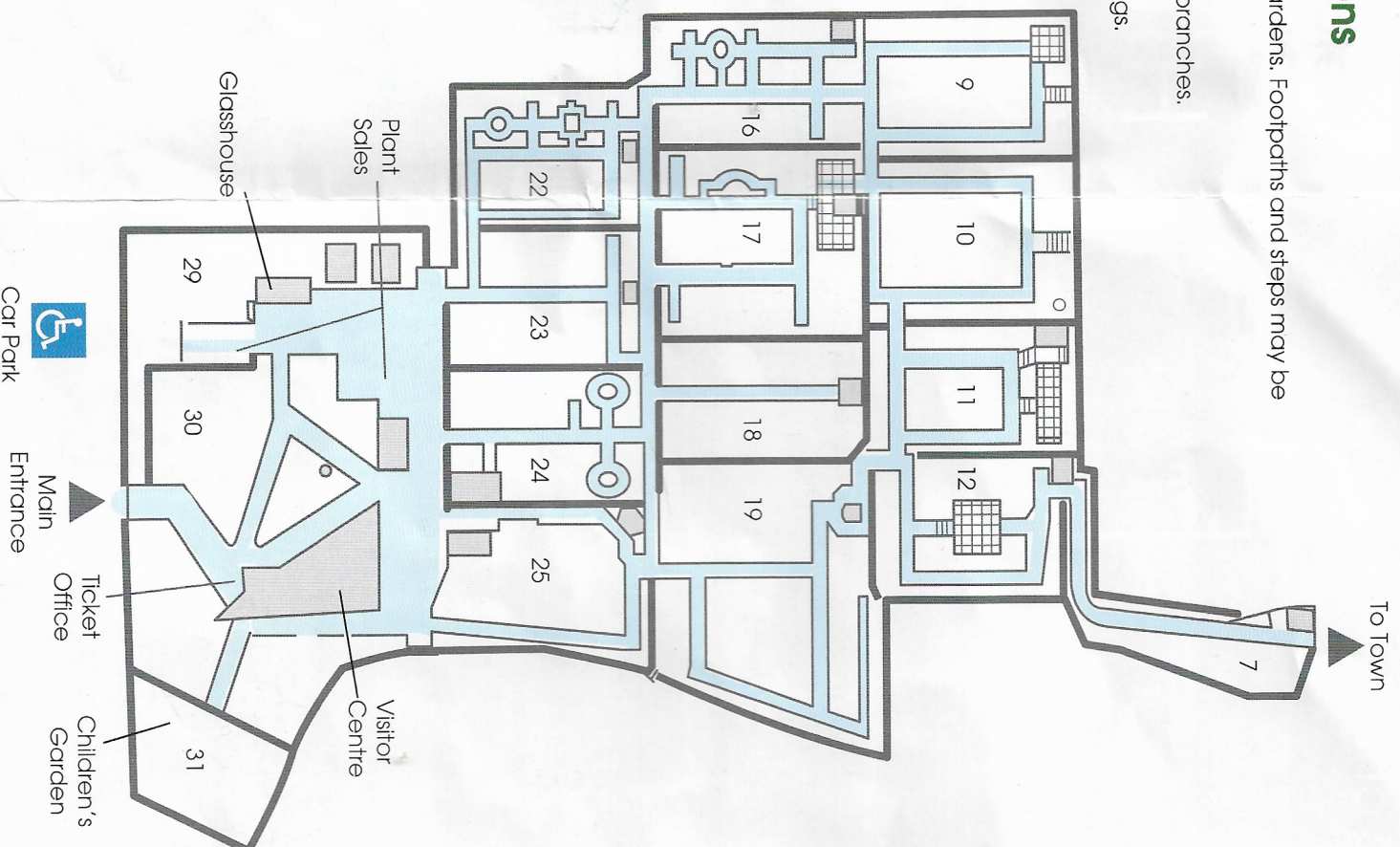

Information

Children are always welcome but must be accompanied at all times

Assistance dogs only

Plants and seasonal produce are on sale in the plant sales area (located on the map)



The Visitor Centre

Self-service refreshments are available Monday-Friday throughout the year. The tearoom is open on weekends and bank holidays from April-October.

There are toilets available, including a disabled toilet and baby changing facilities.

The Centre can be hired for meetings or social events. Pick up a leaflet or contact the Centre Manager on **01926 493339** or email **centremanager@hcgf.org.uk**

Membership - Yearly membership available.

Interested in volunteering? - Join our much-valued volunteers working either in the tearoom, in the gardens or helping with education events. Please ask to find out more.

www.hillclosegardens.com

Hill Close Gardens, Bread & Meat Close, Warwick, CV34 6HF
Company registered in England No 3981067
Registered Charity Number 1085278

